

GENERAL SITE PLAN NOTES - E0.02

- REFER TO DRAWING E0.01 FOR LEGENDS, ABBREVIATIONS AND GENERAL NOTES.
- THE LIGHTING PHOTOMETRIC DRAWING IS FOR REFERENCE ONLY. SEE LIGHT FIXTURE SCHEDULE FOR SITE LIGHTING TYPES.

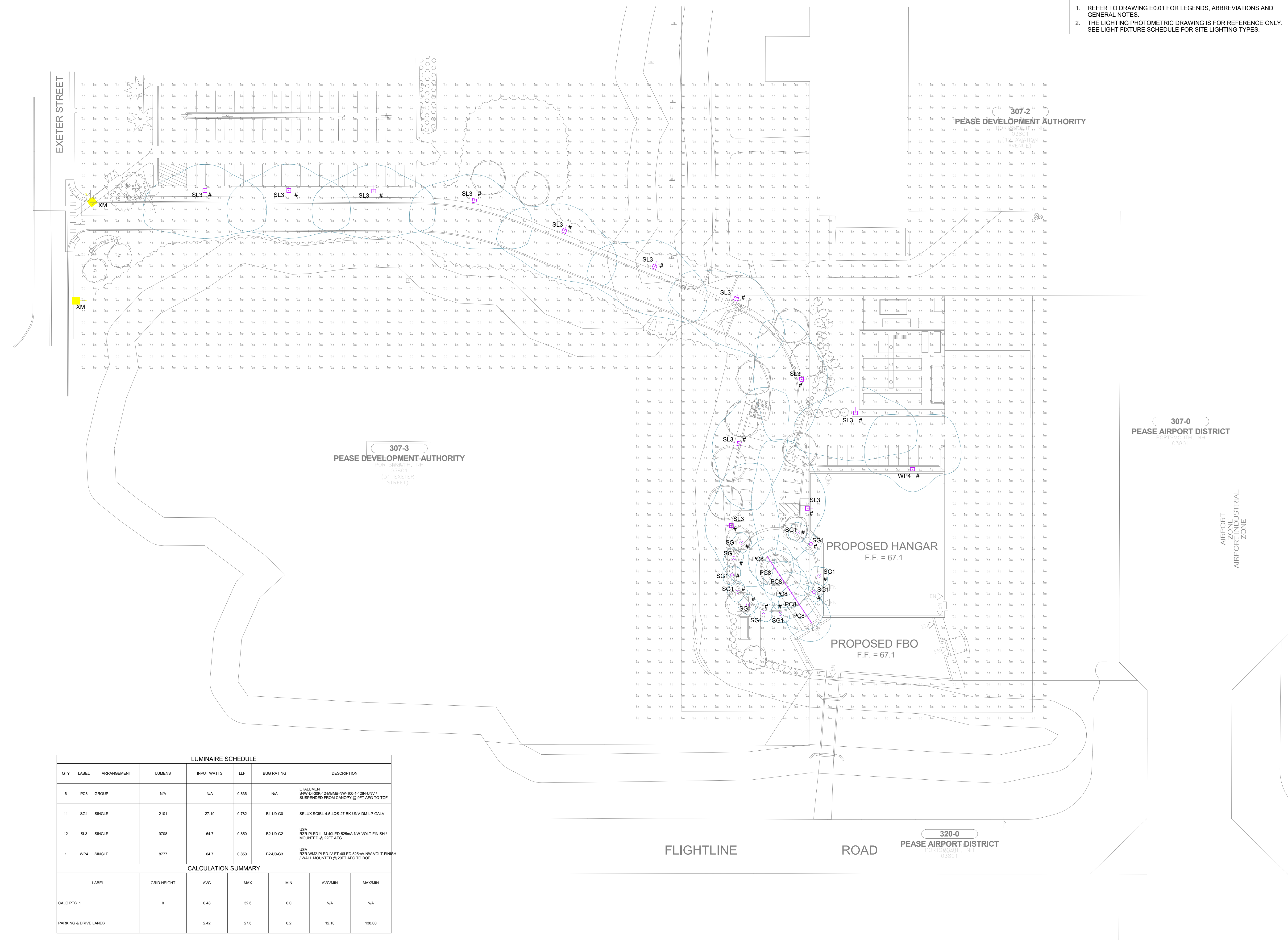

LUMINAIRE SCHEDULE							
QTY	LABEL	ARRANGEMENT	LUMENS	INPUT WATTS	LLF	BUG RATING	DESCRIPTION
6	PC8	GROUP	N/A	N/A	0.836	N/A	ETALUMEN 84W/20K/12AMB/NW-100-1/12IN/UNV / SUSPENDED FROM CANOPY @ 8FT AFG TO TOP
11	SG1	SINGLE	2101	27.19	0.782	B1-U0-G0	SELLUX SCIBL-4-5-4QS-27-8K/UNVDM-LP-GALV
12	SL3	SINGLE	9708	64.7	0.850	B2-U0-G2	USA R2R-PLD-III-M-40LED-525mA-NW-VOLT-FINISH / MOUNTED @ 22FT AFG
1	WP4	SINGLE	8777	64.7	0.850	B2-U0-G3	USA R2R-PLD-IV-FT-40LED-525mA-NW-VOLT-FINISH / WALL MOUNTED @ 22FT AFG TO BOF
CALCULATION SUMMARY							
LABEL	GRID HEIGHT	AVG	MAX	MIN	AVGMIN	MAXMIN	
CALC PTS_1	0	0.48	32.6	0.0	N/A	N/A	
PARKING & DRIVE LANES		2.42	27.6	0.2	12.10	136.00	

JSA
 ARCHITECTS
 INTERIORS
 PLANNERS
 273 CORPORATE DRIVE
 PORTSMOUTH, NH 03801
 T 603.436.2551
 F 603.436.6973
 www.jsainc.com

DESIGN ARCHITECT
Bexhill Group
 1907 Sabine Street, Suite 140
 Houston, TX 77007
 713 300 4999

CIVIL
Hoyle Tanner & Associates, Inc.
 Pease International Tradeport
 100 International Drive, Suite 360
 Portsmouth, NH 03801
 603-413-2904

STRUCTURAL
Summit Engineering
 5 Greenleaf Woods Drive, #302
 Portsmouth, NH 03801
 t. (603) 319-1817

MEP FP
CSI Engineering LLC
 Portsmouth, NH 03801
 Tel # 603-319-8244



MILLION AIR - PEASE
MILLION AIR
 EXETER ROAD
 PORTSMOUTH, NH 03801
 Sullivan Construction, LLC.



Scale: 1" = 40'-0"
 Date: 02.18.2022
 Project Number: 2021-167

REVISIONS		
NO.	DESCRIPTION	DATE

85% PROGRESS - NOT FOR CONSTRUCTION
SITE PLAN LIGHTING PHOTOMETRICS

E0.02
 COPYRIGHT © 2022

6/30/2022 12:09:28 PM C:\Users\skelly\Documents\2021-167 Million Air at Pease_Electrical_sansara.rvt

1 SITE PLAN LIGHTING PHOTOMETRICS
 1" = 40'-0"